



# Quick Installation Guide

*This guide describes how to install the Smart WiFi & APP. Including APP download, register an account, create PV plant. In order to prevent improper operation before use, please carefully read this manual.*

## 1 WiFi Stick Installation

### Step 1 :

Plug the Smart WiFi 2.0 into WiFi/GPRS port under the bottom (underside) of the inverter.

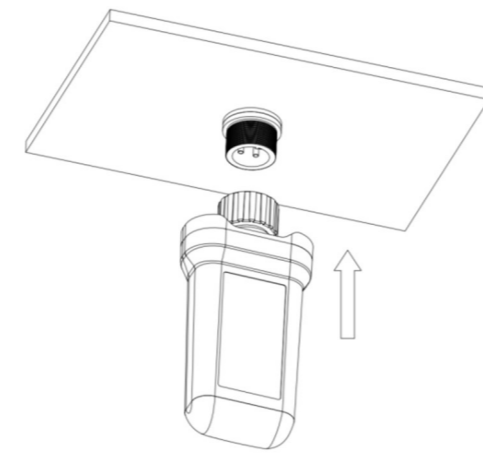

### Step 2 :

Tighten the nut clockwise as following.

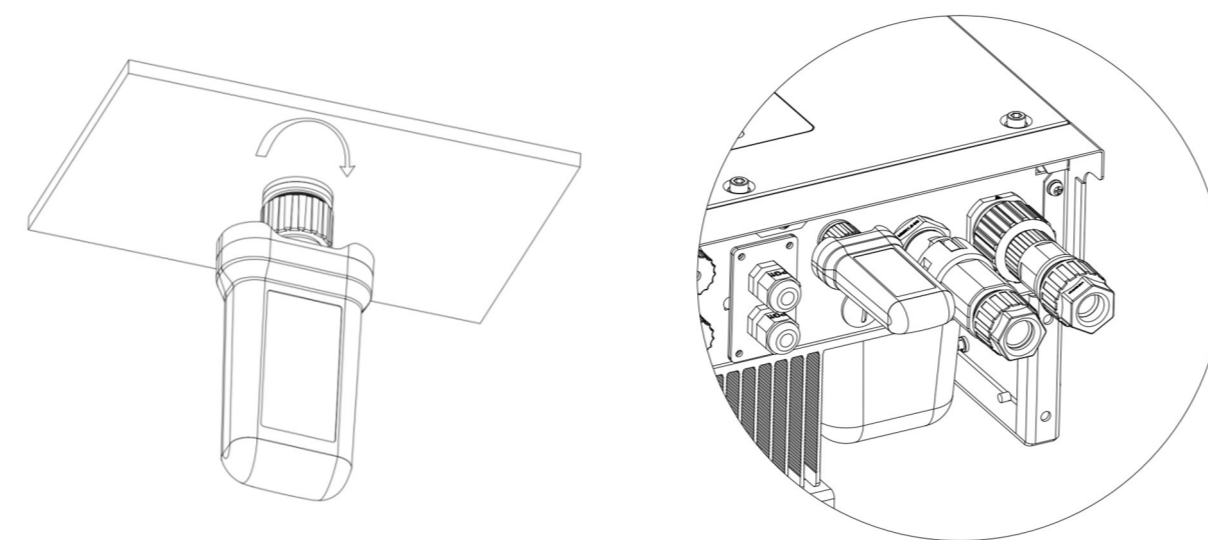

### Step 3 :

Power on the inverter (in accordance with the start-up procedure detailed in the inverter installation manual).

## 2 App Installation

Scan the QR Code below to download and install the FoxCloud App on your smart phone.



## 3 Configuration



### Step 1 :

Connect your mobile device with Smart WiFi.

The SSID of the Smart WiFi is 'W-xxxxx' and the password is 'mtmt2020'.

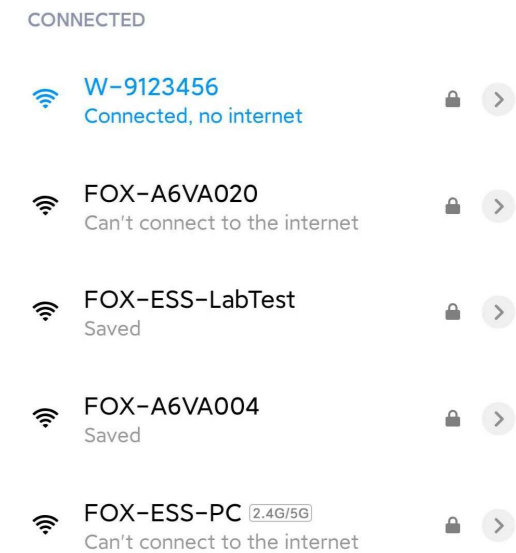

### Step 2 :

After connecting successfully. Open any browser and enter '192.168.1.1' on the address bar on Top.

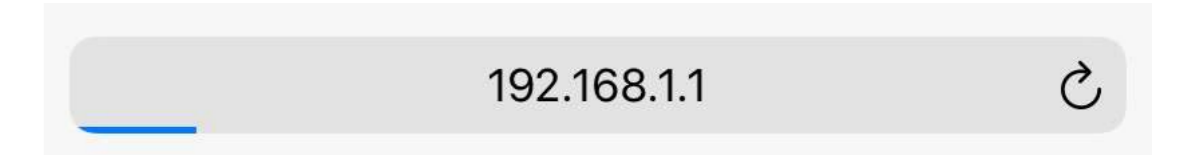

**Step 3 :**

Scroll down in the WiFi SSID menu to find house router and input the house router's password. Click 'Save'.



**For Computer Users:**

CONNECTED

- W-9123456  
Connected, no internet
- FOX-A6VA020  
Can't connect to the internet
- FOX-ESS-LabTest  
Saved
- FOX-A6VA004  
Saved

**Step 1 :**

Connect your PC or Laptop with Smart WiFi.  
The SSID of the Smart WiFi is 'W-xxxxx' and the password is 'mtmt2020'.

**Step 2 :**

After connecting successfully. Open any browser and enter '192.168.1.1' on the address bar on top.

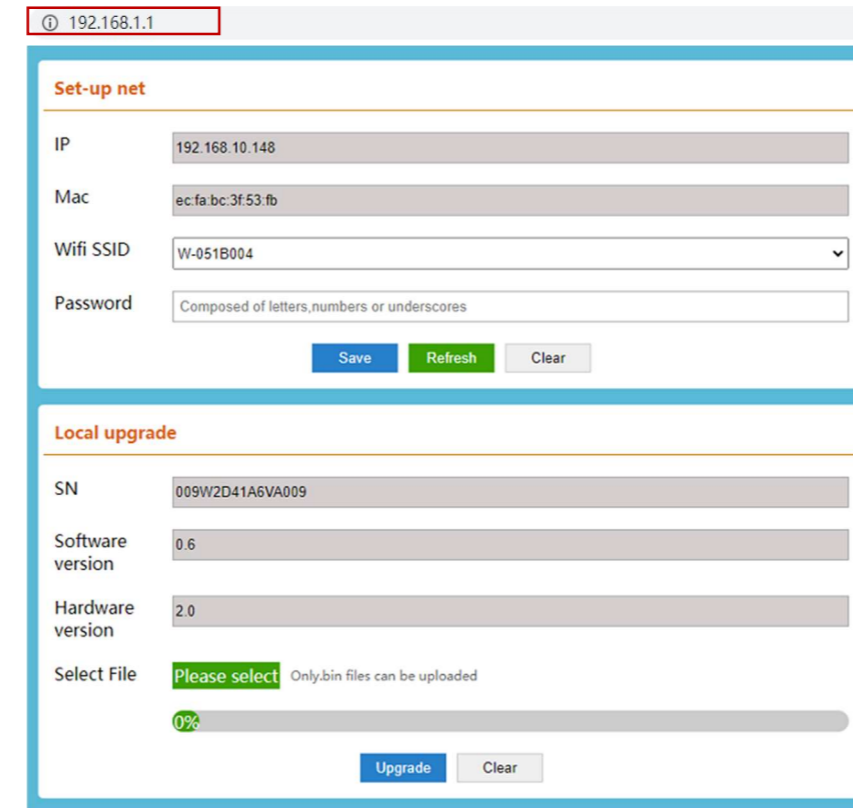

**Step 3 :**

Scroll down in the WiFi SSID menu to find house router and input the house router's password. Click 'Save'.

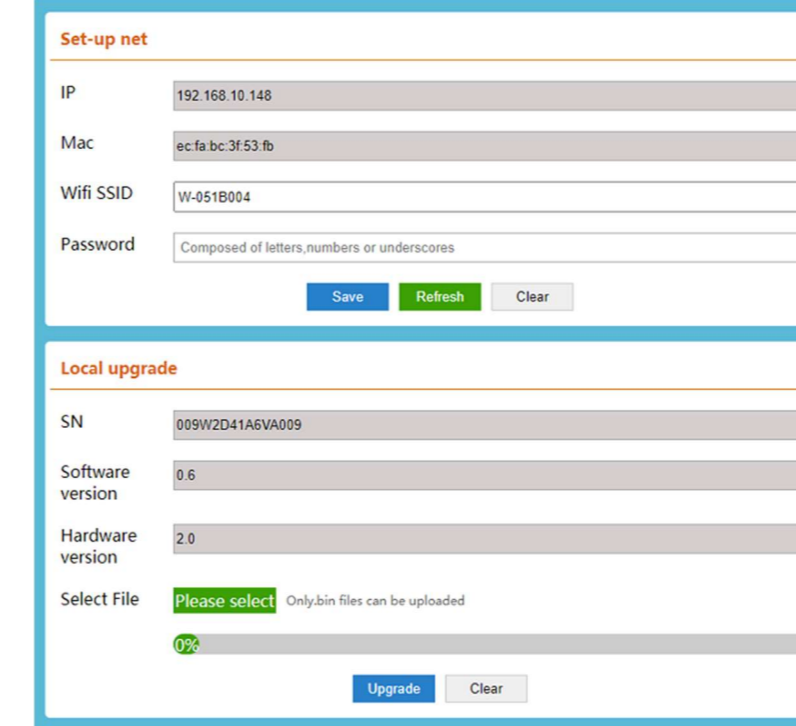

**4 Registering As An Installer Account**



**For Smartphone Users:**

**Step 1 :**

Please click 'Register', enter installer's information and click 'Register' to complete the installer account registration.

**Note:** \* If you already have an installer/agent account, please press login and enter with your installer/agent account directly.

\* If you are end user, please contact your installer for following steps.



**Step 2 :**

Select your installer and enter the invitation code, and click ‘Join’ .

**Note:** \* Installer: the installation company  
Agent: the agent/distributor company  
installation company purchase from

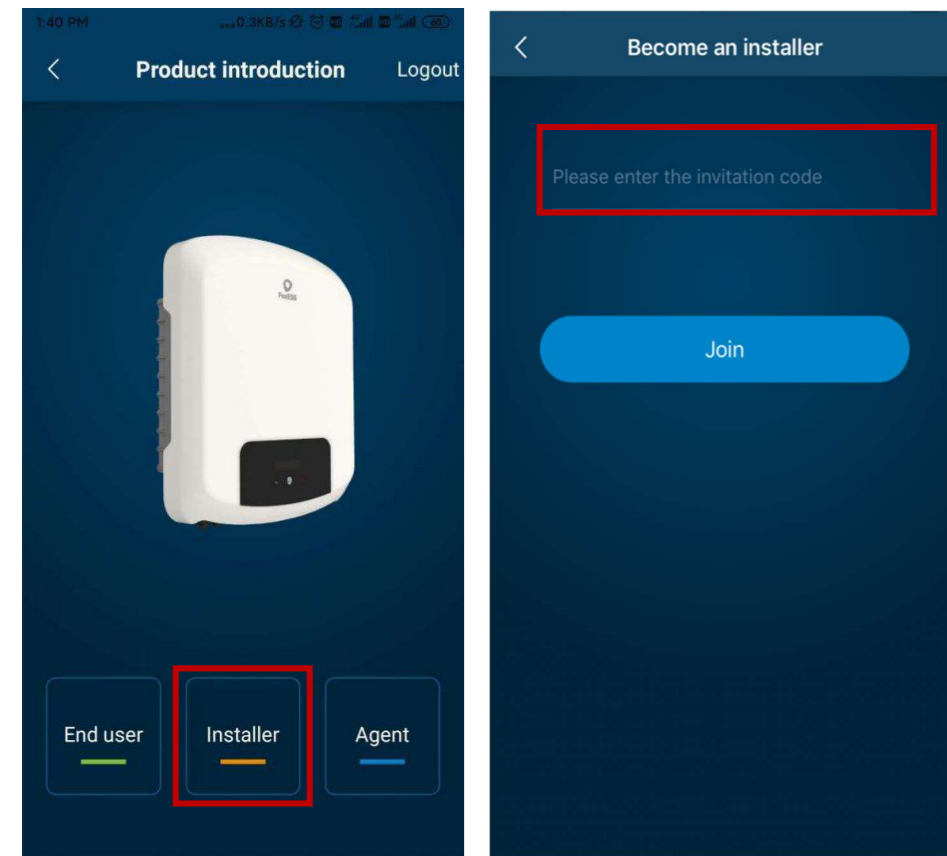

**For Computer Users:**

**Step 1 :**

Open any browser and enter [www.foxesscloud.com](http://www.foxesscloud.com) on the address bar on Top, click ‘Sign up’ .

**Note:** \* If you already have an installer/agent account, please press ‘Sign in’ and enter with your installer/agent account directly.

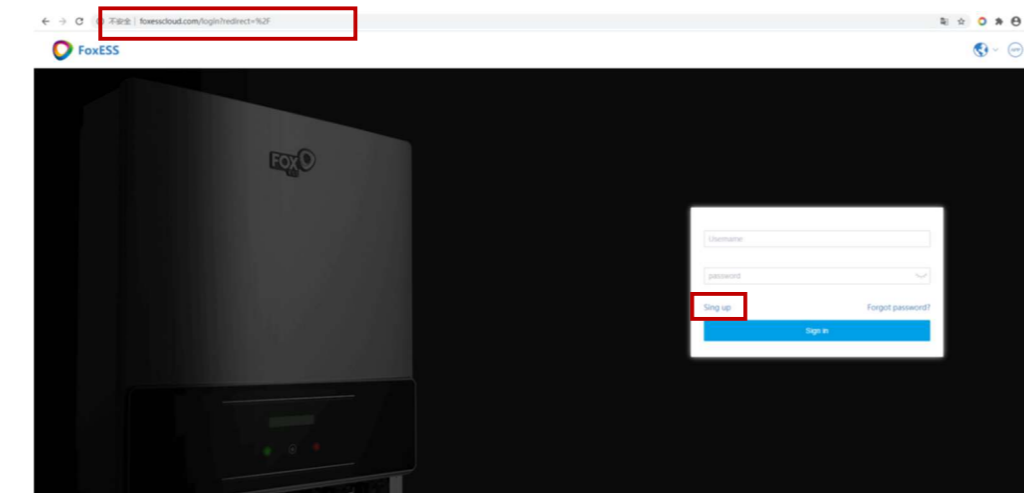

**Step 2 :**

Enter information and click ‘Sign up’ to complete account registration.

**Note:** \* If you are end user, please contact your installer for following steps.

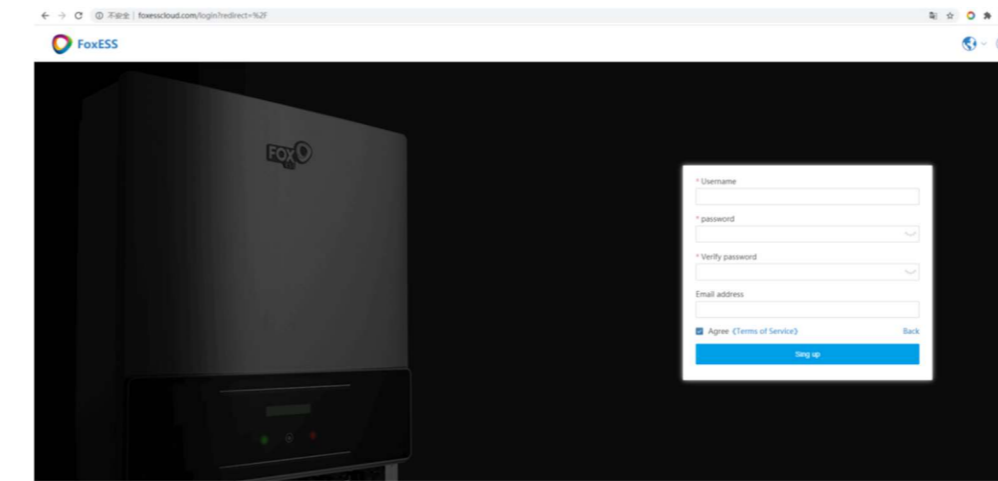

**Step 3 :**

Please select installer and enter the invitation code, and click ‘Register’ .

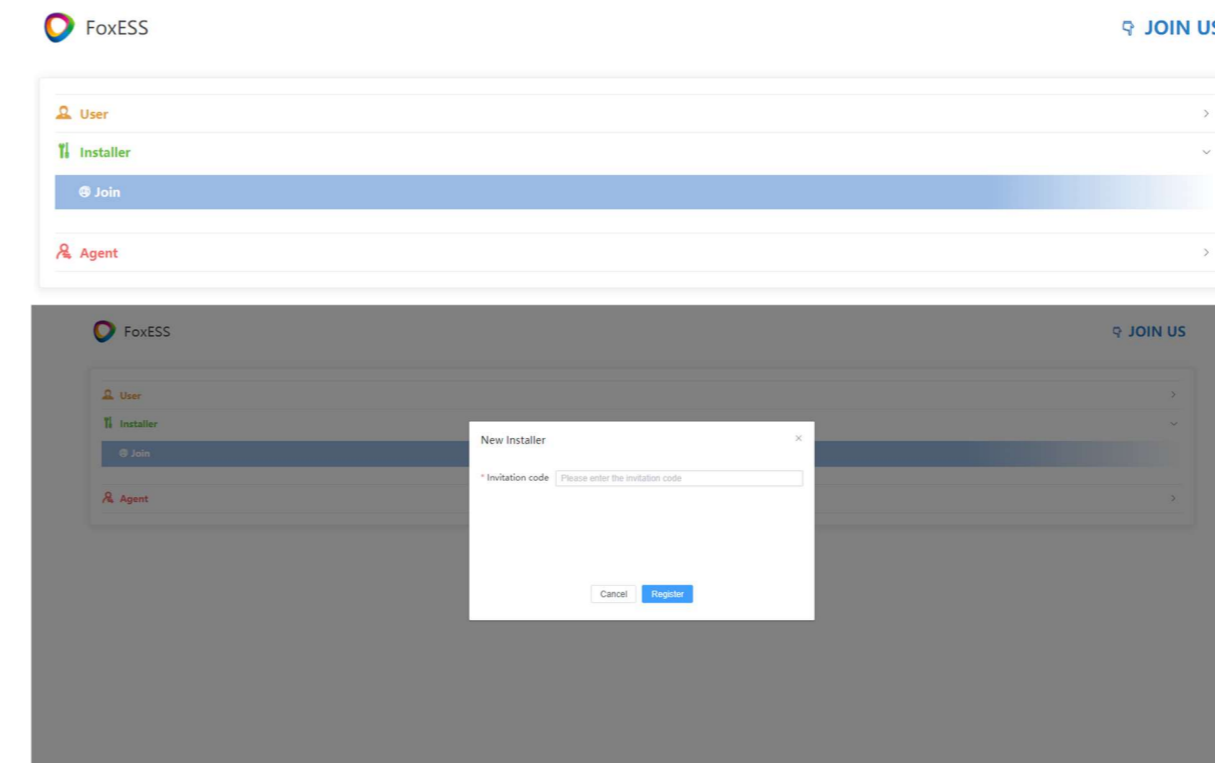

**5 Create A Plant**



**For Smartphone Users :**

**Step 1 :**

Open the App, and login with your Installer/agent account.

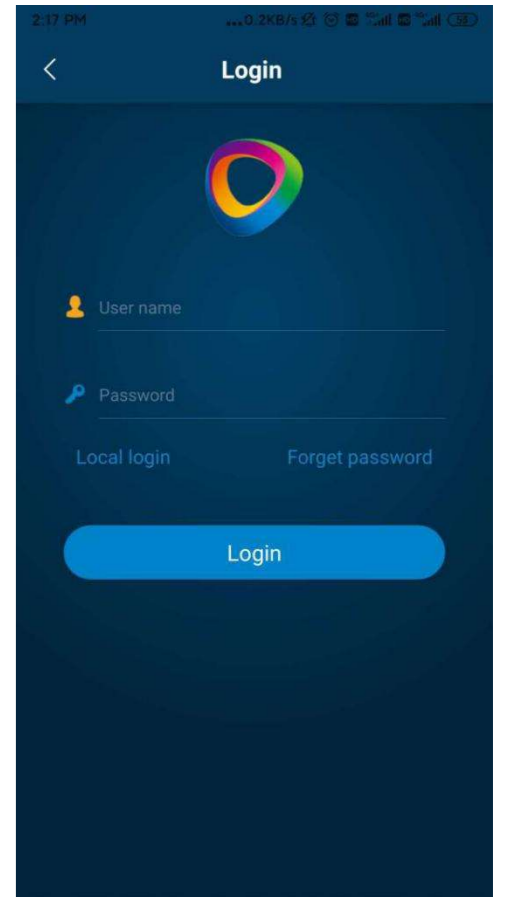

**Step 2 :**

Press the ‘+’ icon on the homepage to add plant. Press the scan icon next to the ‘Device’ list to scan the QR code label on

the side of the Smart WiFi. Some basic information for this plant will populate automatically. Complete all required information and click ‘OK’ on the top right corner of the page.

**Note:** \* After starting the APP, it will pop-up an message ‘Whether to allow positioning permissions’, please select ‘Allow’. For the capacity, please fill in the actual capacity of the installation of solar panels.

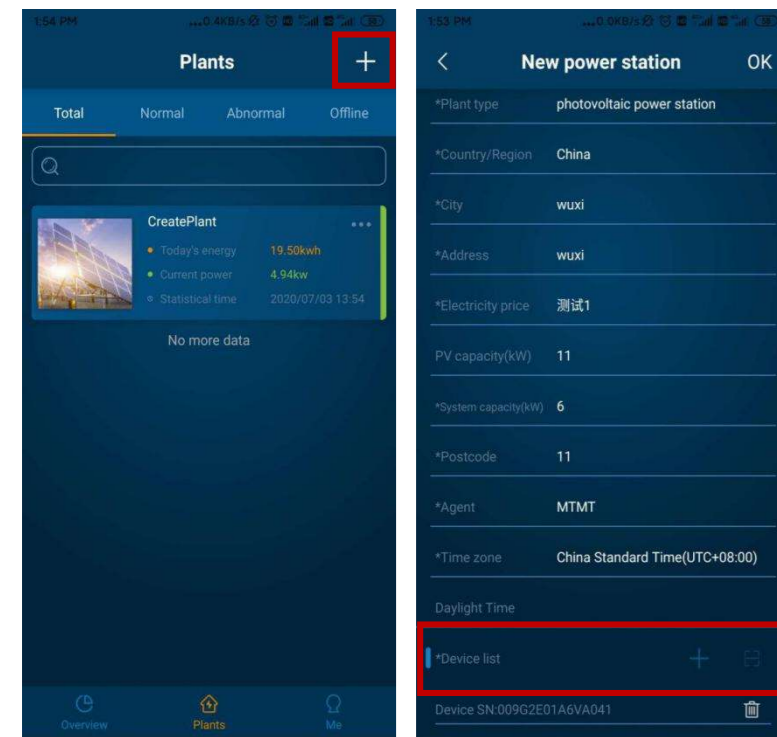

**For Computer Users:**

Press the ‘New’ on the homepage to add plant. Complete all required information and click ‘Create’ .

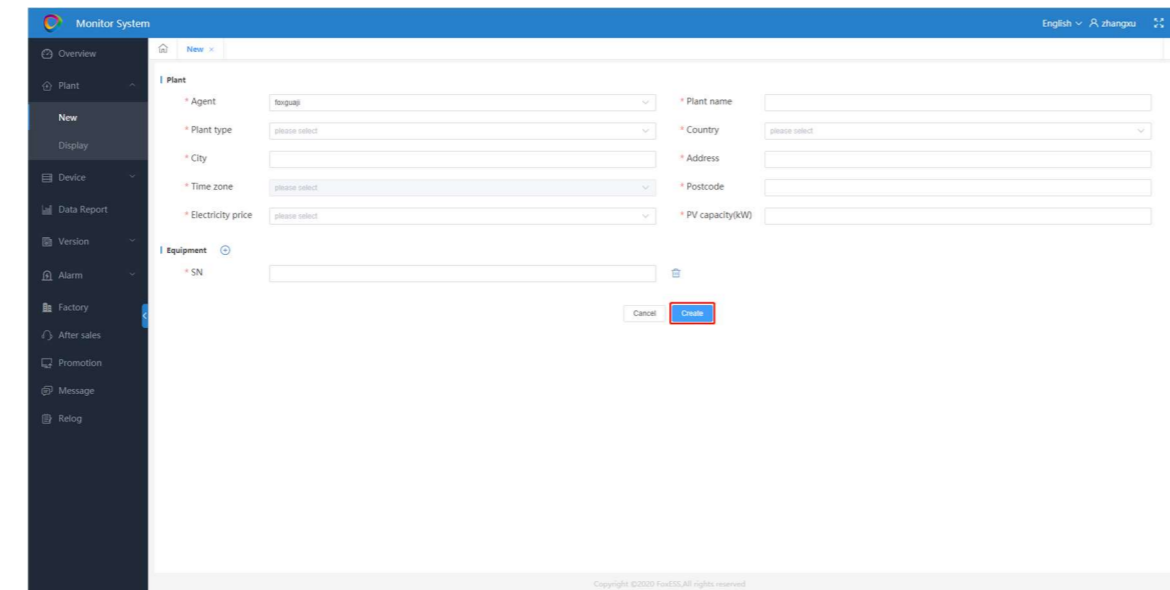

**6 End User Account Registration And Sign Up**



**For Smartphone Users :**

**Step 1 :**

Please click ‘Register’ , enter end user’ s information and click ‘Register’ to complete the end user account registration.

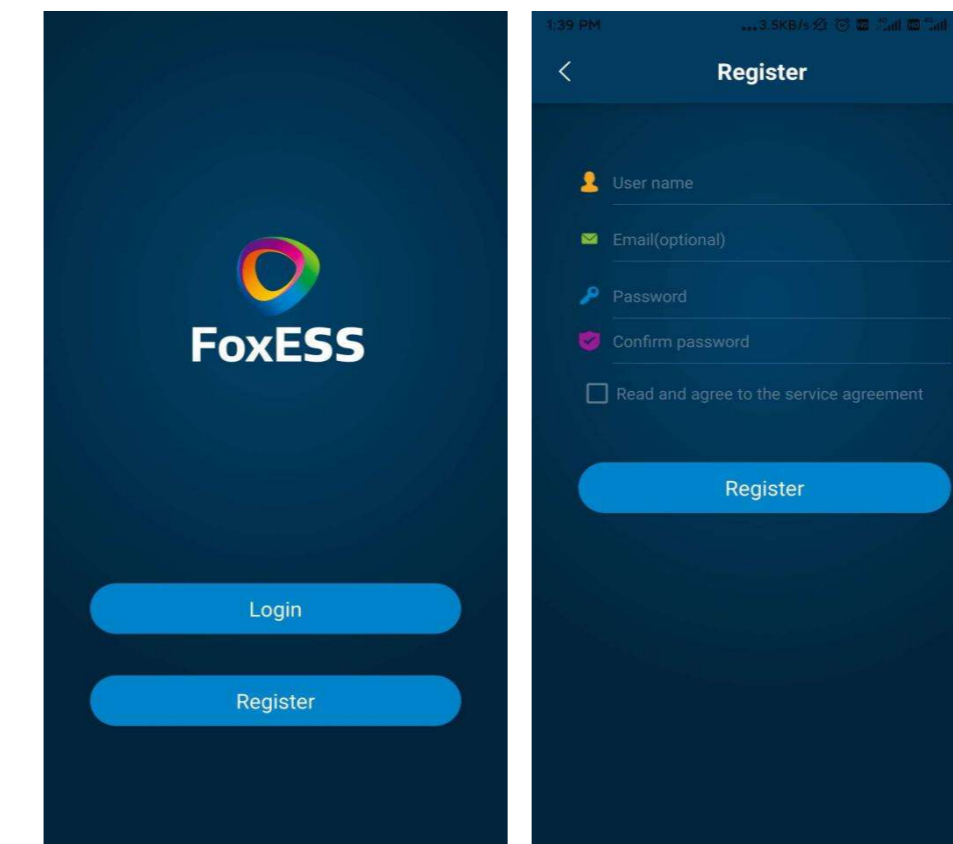

**Step 2 :**

Select end user then scan the WiFi bar code on the Smart WiFi, and click ‘OK’ .

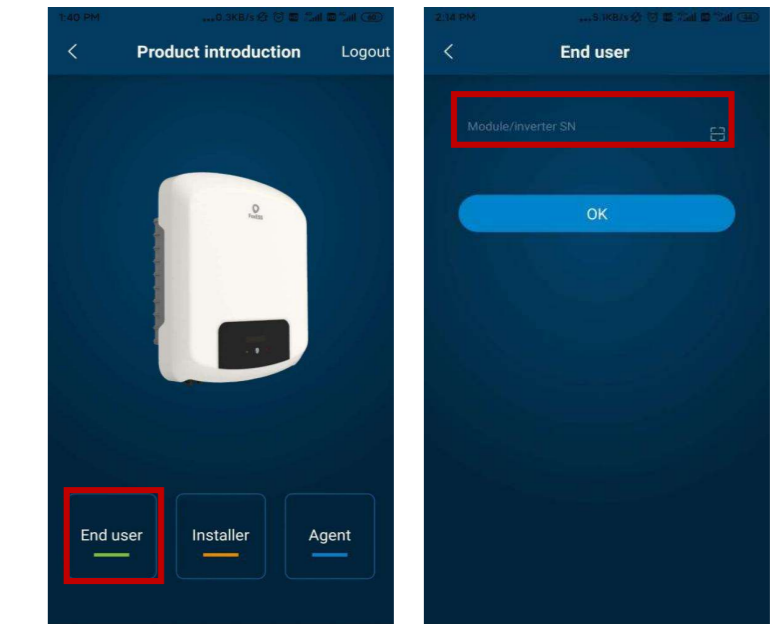

**For Computer Users:**

Please select end user then input the SN, and click ‘Register’ .

